

## AUTOMATIC MEASURING STATION KS-579 FOR GEOMETRY CONTROL OF FINAL RAILWAY AXLES

This equipment is based on the principle of contact measurement, and is set up with four measuring arms, lying next to each other on a linear guidance system. Each arm has its own longitudinal metering and an independent servodrive, which means that it can move longitudinally, and measure at a random section. For measurement of radiuses and derived lengths is used optical system.

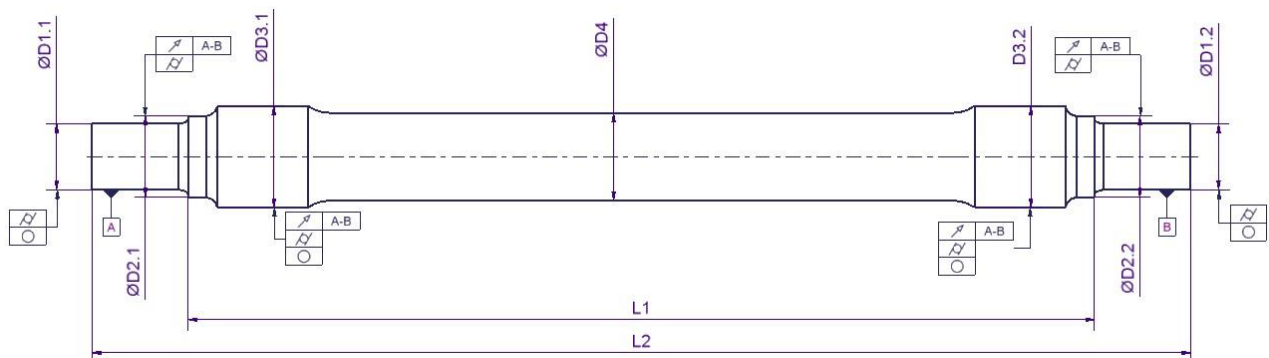

### Example of measured parameters



### Basic technical parameters

#### Range of measured parts:

- diameter: 115 – 220 mm
- length: 2100 – 2550 mm (with possibility of flexible adjustment to another range)
- weight: to 1000 kg

**Time of measuring cycle:** cca 120 s (for measurement at 20 sections)

## Measured parameters

Device is able to measure these parameters:

- diameters
- lengths
- circularity
- cylindricity
- radial run-out
- axial run-out
- radiuses

**Measurement accuracy (repeatability):**

- diameters  $\pm 1 \mu\text{m}$
- lengths  $\pm 0,005 \text{ mm}$

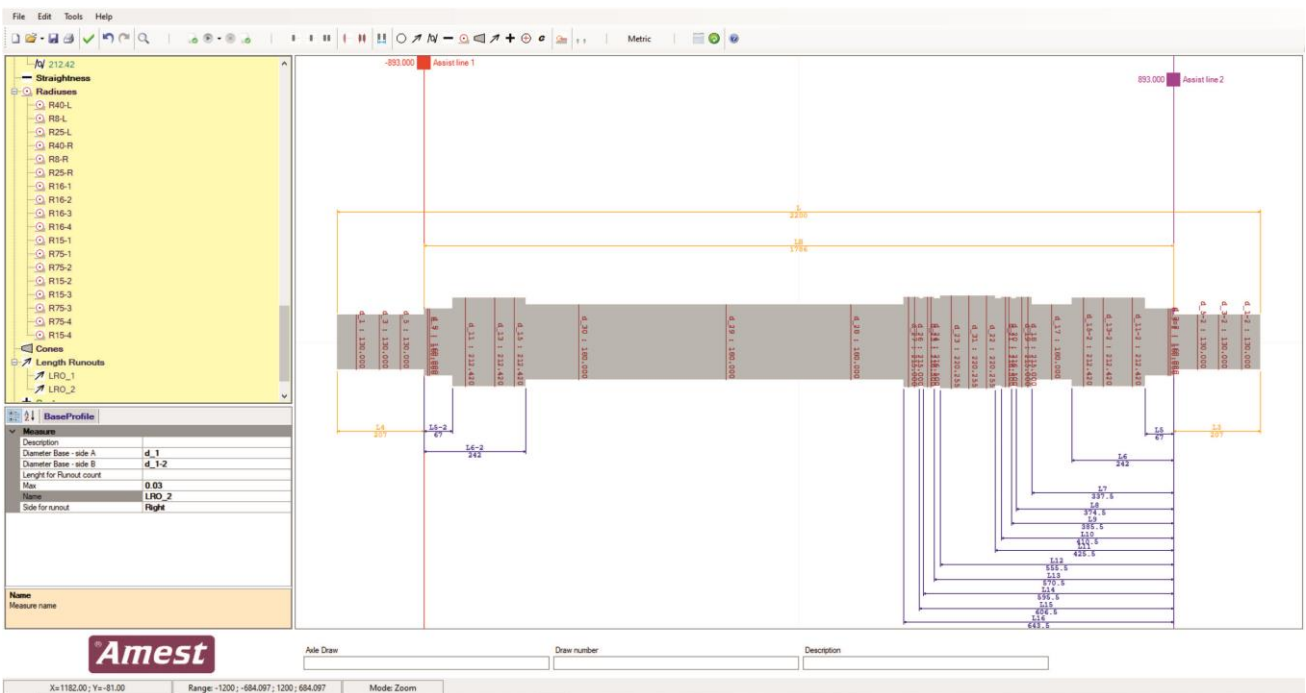
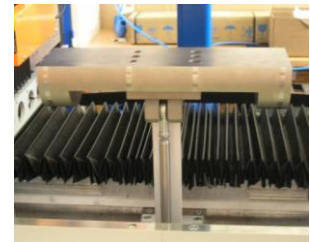
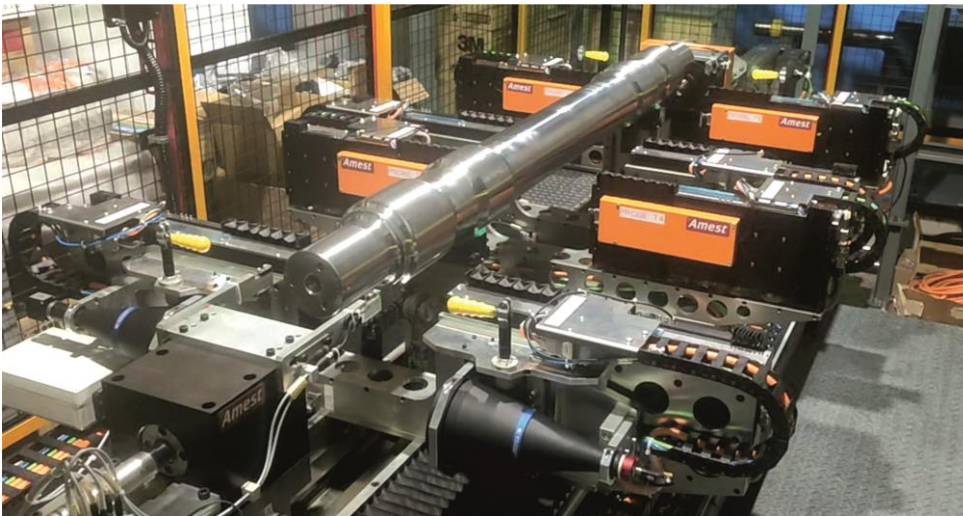

Belnická 736  
CZ-252 42 Jesenice

+420 246 051 114  
+420 272 705 754

<http://www.amest.cz>

e-mail : info@amest.cz